

# CREST 2807 SLOTTED TOE RAIL



Crest Aluminum Products Inc  
Part No. C-2807  
Slotted Toe Rail

MARINE PRODUCTS  
www.crestaluminum.com

FRONT VIEW

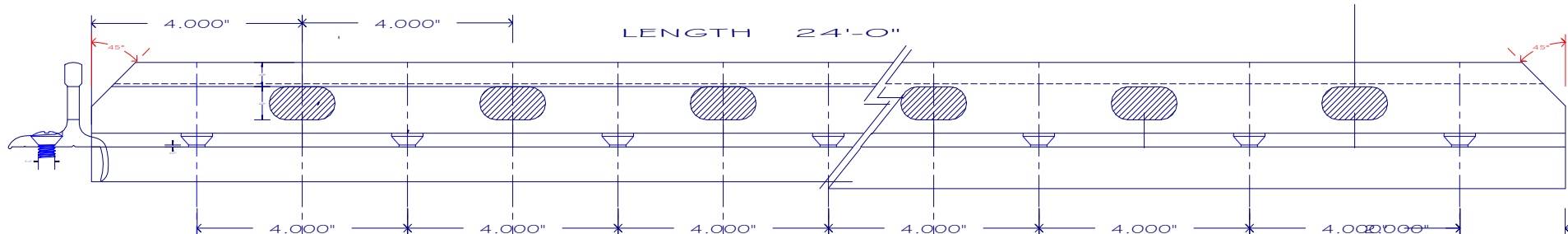

TOP VIEW

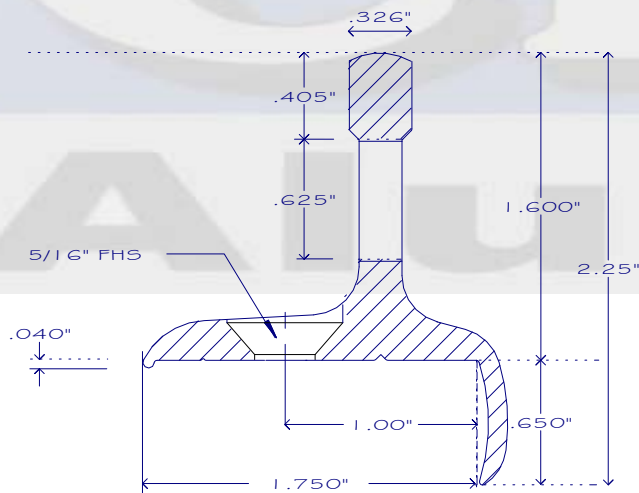
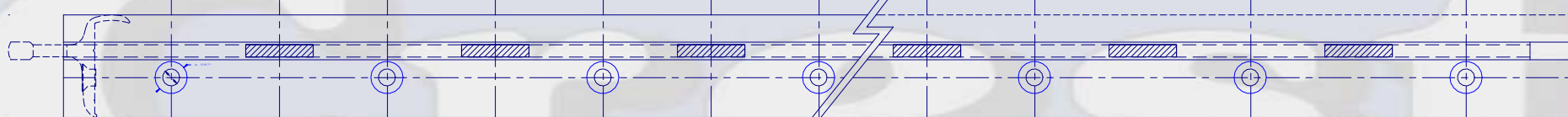

SECTION VIEW  
ACTUAL SIZE

Hole Dimensions  
Std 5/16 -18  
Phillips Oval Head Screws

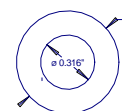
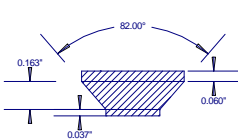
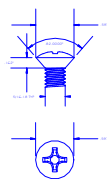

72 Holes  
Dia .316" +.002" -0.0"

Slot Dimensions

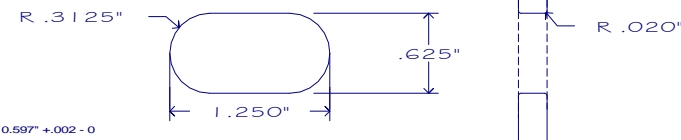

Notes:

- Alloy: 6061 T-6
- Finish: Hard Coat Anod.  
30 Min Clr. Velo
- Lengths: 24'-0"
- Slots: 4" On Center
- Wt./ Ft.: .959 lbs.

PART NO	C-2807		Crest Aluminum Products Inc 8287 Tyler Blvd Mentor OH 44060 USA	REVISIONS	DATE
ALLOY	6061 T-6				
FINISH	BLK HDCT ANOD 30 MIN CLR VELO	JOB NO.	DATE: 07-24-2023		
LENGTHS	24'-0"	CUSTOMER / PROJECT			
UNSPEC RADIUS	.016"	2807 SLOTTED TOE RAIL			
DRAWING BY:	J. M. ALLIN	© Crest Aluminum Products Inc 2006 J.M. Allin			